

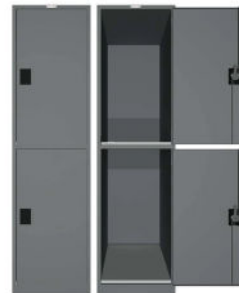

# Premier Lockers

AUSTRALIA'S LOCKER SPECIALIST



## LUGGAGE STEEL LOCKER

Premier Luggage Lockers are designed to securely store heavy luggage items. They are ideal for workplaces and public places. Originally developed as a solution for Fly-In / Fly-Out (FIFO) mining camps, our Luggage lockers has since proven incredibly popular within the hospitality industry as well as transport hubs and retail locations.

### FEATURES

- ▶ Made from heavy gauge steel
- ▶ Environmentally friendly 100% recyclable steel
- ▶ Reinforced compartment bases to carry heavy loads
- ▶ Full length and extended width internal door reinforcing
- ▶ Hardened steel rivets greatly increase shelf load capacity
- ▶ Welded frame provides strength and stability
- ▶ Perimeter door surround, prevents the doors from being forced inwards
- ▶ Full length internal door reinforcing for added strength
- ▶ 180 degree opening doors
- ▶ Powder coat finish
- ▶ 10 Year Warranty



**P: 1300 202 557**

[www.premier-lockers.com](http://www.premier-lockers.com)

[sales@premier-lockers.com](mailto:sales@premier-lockers.com)

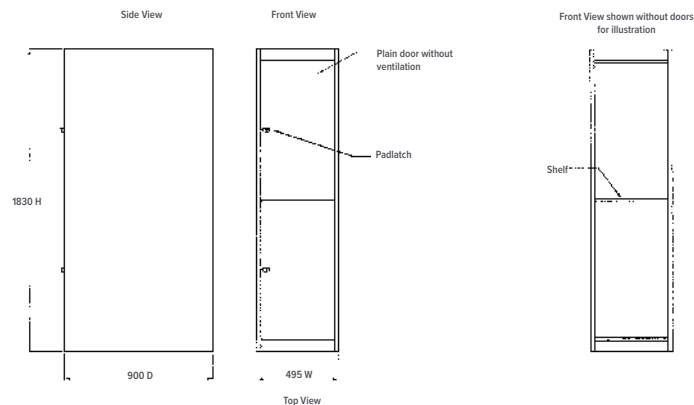

## COLOURS AVAILABLE

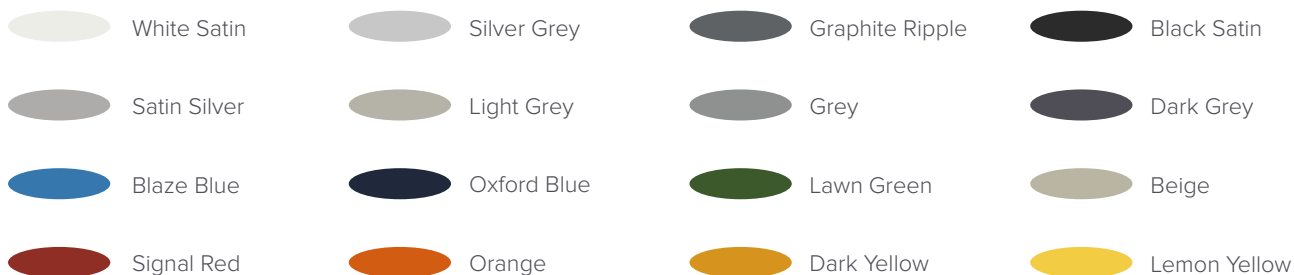

10 - 12 week lead time for luggage lockers.  
Contact your local sales representative for more information.

## STANDARD LOCK OPTIONS

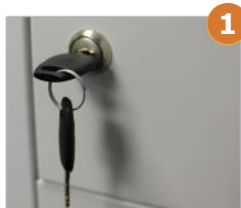

1



2

1. Key Lock
2. Pad-latch Lock

## ACCESSORIES

- Sloping top
- Locker bench
- Locker Stand
- Locker Numbering
- Corner Infill
- Plinths

## PERFORATION CUSTOMISATION

1. Square Holes
2. Round Edge Staggered Slots
3. Circular Holes
4. Circular Staggered Holes
5. Diamond Holes
6. Angled Round Edge Slots

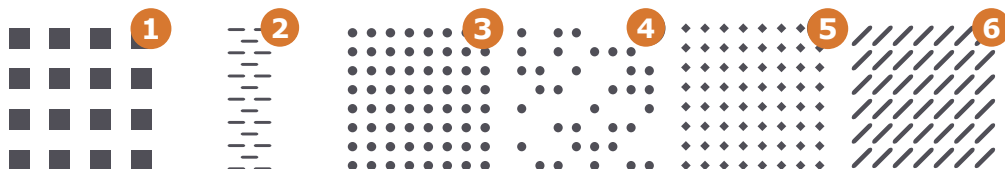

## TECHNICAL SPECIFICATIONS

CODE	DESCRIPTION	DIMENSIONS
	Luggage Locker (495mm Wide)	1830H x 495W x 900D

**P: 1300 202 557**  
[www.premier-lockers.com](http://www.premier-lockers.com)  
[sales@premier-lockers.com](mailto:sales@premier-lockers.com)