



Premier Lockers

AUSTRALIA'S LOCKER SPECIALIST



LUGGAGE STEEL LOCKER

Premier Luggage Lockers are designed to securely store heavy luggage items. They are ideal for workplaces and public places. Originally developed as a solution for Fly-In / Fly-Out (FIFO) mining camps, our Luggage lockers has since proven incredibly popular within the hospitality industry as well as transport hubs and retail locations.

FEATURES

- ▶ Made from heavy gauge steel
- ▶ Environmentally friendly 100% recyclable steel
- ▶ Reinforced compartment bases to carry heavy loads
- ▶ Full length and extended width internal door reinforcing
- ▶ Hardened steel rivets greatly increase shelf load capacity
- ▶ Welded frame provides strength and stability
- ▶ Perimeter door surround, prevents the doors from being forced inwards
- ▶ Full length internal door reinforcing for added strength
- ▶ 180 degree opening doors
- ▶ Powder coat finish
- ▶ 10 Year Warranty



P: 1300 202 557

www.premier-lockers.com

sales@premier-lockers.com

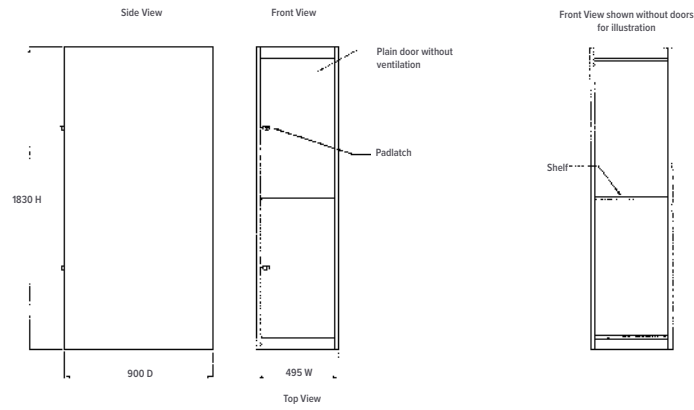

COLOURS AVAILABLE



10 - 12 week lead time for luggage lockers.
Contact your local sales representative for more information.

STANDARD LOCK OPTIONS

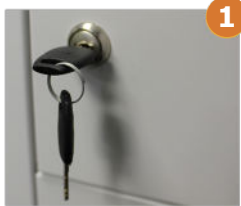

1



2

1. Key Lock
2. Pad-latch Lock

ACCESSORIES

- Sloping top
- Locker bench
- Locker Stand
- Locker Numbering
- Corner Infill
- Plinths

PERFORATION CUSTOMISATION

1. Square Holes
2. Round Edge Staggered Slots
3. Circular Holes
4. Circular Staggered Holes
5. Diamond Holes
6. Angled Round Edge Slots

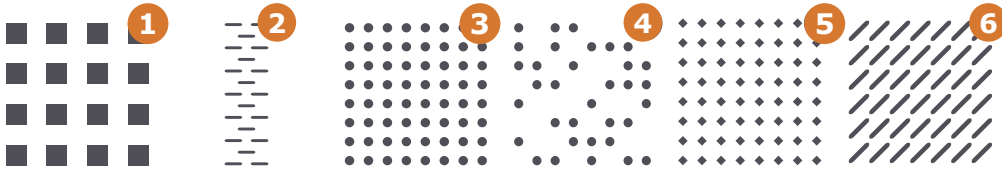

TECHNICAL SPECIFICATIONS

| CODE | DESCRIPTION | DIMENSIONS |
|------|-----------------------------|---------------------|
| | Luggage Locker (495mm Wide) | 1830H x 495W x 900D |

P: 1300 202 557
www.premier-lockers.com
sales@premier-lockers.com